

1 MAIN PARTS SECTION

Note:

1. Parts with no Ref. No. in "EXPLODED VIEW" are not supplied. And some Ref. No. will be skipped. Be sure to make your orders of replacement parts according to the parts list.
2. The parts indicated by the dotted line  are for Assy only and are not supplied.
3. Disregard Ref. No. suffixes when ordering parts. They are used to describe parts in "Disassembly/Assembly Procedures" section.

COMPARISON CHART OF MODELS & MARKS

MODEL	MARK	MODEL	MARK
NV-DS29EG	A	NV-DS30EN	I
NV-DS29EGM	B	NV-DS30ENT	J
NV-DS29EB	C	NV-DS30ENC	K
NV-DS29EGE	D	NV-DS30A	L
NV-DS30EG	E	NV-DS50EN	M
NV-DS30EGM	F	NV-DS50ENT	N
NV-DS30B	G	NV-DS50A	O
NV-DS30EGE	H		

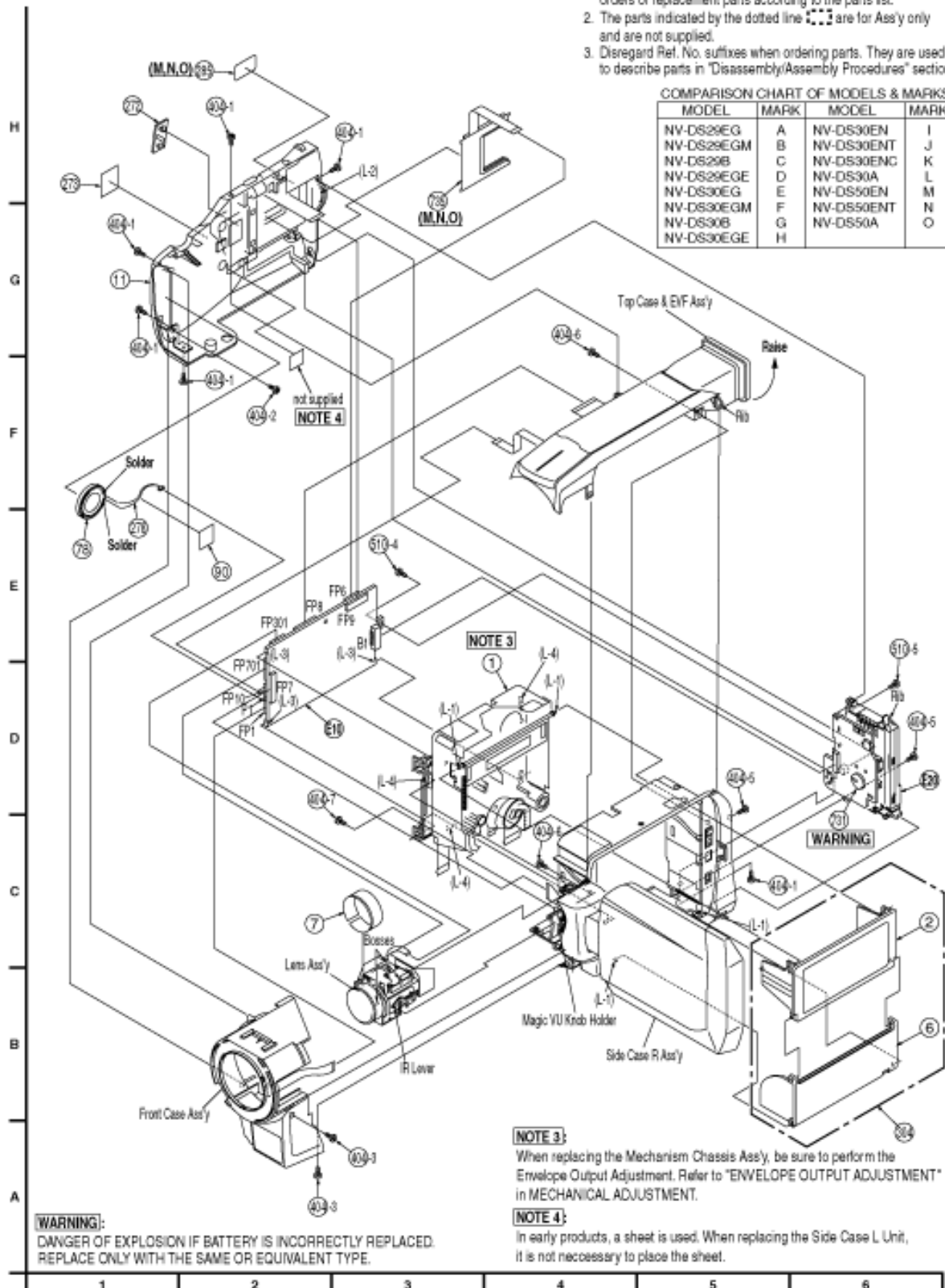

WARNING:
DANGER OF EXPLOSION IF BATTERY IS INCORRECTLY REPLACED.
REPLACE ONLY WITH THE SAME OR EQUIVALENT TYPE.

NOTE 3:
When replacing the Mechanism Chassis Assy, be sure to perform the Envelope Output Adjustment. Refer to "ENVELOPE OUTPUT ADJUSTMENT" in MECHANICAL ADJUSTMENT.

NOTE 4:
In early products, a sheet is used. When replacing the Side Case L Unit, it is not necessary to place the sheet.